



斗式提升机配件

COMPONENTS FOR BUCKET ELEVATOR



components for your success

www.stif.cn

► 中文
► English



公司简介 COMPANY PROFILE

斯缇福机械（苏州）有限公司的成立标志着我们的业务范围在亚洲地区进行扩展。

斯缇福苏州工厂正式成立于2011年6月，它的诞生成功履行了我们在亚洲生产并销于亚洲的发展目标。这些都是基于亚洲地区强烈的客户需求，尤其是中国客户。

斯缇福是专业从事散装物料处理的配件制造商。

我们的产品包括：

- 提升机皮带
- 提升机钢制及塑料畚斗
- 传感器
- 管道连接件及弯管
- 防爆板等

在中国，斯缇福苏州同样致力于提供和法国总部一样的产品品质和可靠性。

斯缇福坚信人力发展的重要性。公司的宗旨是不断强化我们对产品知识的了解，更重要的是要有正确的心态。我们的生产过程是在严格的质量控制和效率下执行的，这只能通过高效的人力才能达到。

我们工厂使用的高品质设备也大大促进了工厂的整体成功。不断投资和设备更新的政策确保了我们在同行业内的领先地位。这项政策适用于斯缇福全球各地的每个工厂。

我们相信了解本地市场是我们长期成功进入中国市场的关键点。我们也坚定地与亚太地区的客户紧密合作，为之开发定制产品并提供合理、具有竞争性的价格。

热烈欢迎您随时和我们联系，相信我们能为您提供更好的服务。

STIF Suzhou signifies the venturing of our business into Asia.

Established in June 2011, our manufacturing facility in China, STIF Suzhou has fulfilled our objective of produce in Asia for Asia. All these are driven by the strong Customers' demand in Asia, especially in China.

STIF is specialized in the production of components for the bulk material handling.

Our product includes:

- Belts for bucket elevator
- Elevator buckets, metallic and plastic
- Sensors
- Compression couplings for pneumatic conveying systems
- Explosion vent panels

In China, STIF Suzhou is committed to provide the similar quality and reliability as our head quarter in France.

STIF strongly believe in the development of our people. The company philosophy is to empower our people with knowledge in-term of our products & most important of all, the right mindset & attitude. Our production process is carried out under high stringent in-term of quality control & efficiencies. This can only be achieved through highly efficient manpower at all levels.

High-quality equipment used in our factory also contributes greatly to our overall success. Our policy of constant investment & renewal of equipment maintain our leading position in our field. This policy applies to any entity around the globe.

Entering into China, we believe understanding the market & localization is crucial for our long-term success. We are strongly committed to work closely with customers in this region to develop customized products & make it as our standard range with reasonable price.

You are most welcome to contact us so as to explore further about what we could provide & serve you at best.

STIF SUZHOU
CHINA
sales@stif.cn

STIF ASIA
SINGAPORE
sales@stif.com.sg

STIF INDONESIA
INDONESIA
indo@stif.com.sg



目录 CONTENTS

提升机畚斗 ELEVATOR BUCKETS

如何选择畚斗材质	Elevator Bucket: How to choose the material	4
畚斗目录	Contents JET	5
JET CC 塑料畚斗	JET CC Plastic HDPE, PA6, PU	6
JET CC-LP 塑料畚斗	JET CC-LP Plastic HDPE, PA6, PU	7
JET 钢畚斗	JET Pressed steel	8
JET 塑料畚斗	JET Plastic HDPE, PA6, PU	9
Euro JET 钢畚斗	Euro JET Pressed steel	10
Euro JET 塑料畚斗	Euro JET Plastic HDPE, PA6, PU	11
焊接钢畚斗	JET Welded steel	12
如何测量畚斗	How to measure a bucket	13
畚斗螺栓	Bolts	14

提升机皮带 ELEVATOR BELTS

皮带目录	Contents BELTJET	15
耐油型提升机皮带	JETOIL: Oil Resistant Elevator Belt	16
VLE耐油型提升机皮带	JETOILVLE: Oil Resistant Elevator Belt	17
阻燃型提升机皮带	JETFLAM: Flame Resistant Elevator Belt	18
VLE超耐油阻燃型提升机皮带	JETFLAM SUPER OILVLE: Flame Resistant Elevator Belt	19
耐磨型提升机皮带	JETABRA: Anti Abrasive Elevator Belt	20
耐高温型提升机皮带	JETTHERM: High Temperature Elevator Belt	21
VLE食品级提升机皮带	JETFDAVLE: Food Quality Elevator Belt	22



如何选择畚斗材质

ELEVATOR BUCKET: HOW TO CHOOSE THE MATERIAL

材质 MATERIAL	普通钢 Steel	不锈钢304L Stainless steel 304L	不锈钢316L Stainless steel 316L	高密度聚乙烯 HDPE	聚酰胺 PA 6	聚氨酯 PU
使用寿命 LONGEVITY	***	****	****	*	***	***
物料粘性 STICKY PRODUCTS	***	***	***	*	***	***
抗冲击能力 IMPACT PERFORMANCE	*	***	***	**	***	***
是否食品级 FOOD GRADE	X	✓	✓	✓	✓	✓
连续工作温度 CONTINUOUS TEMPERATURE °C	+180°C -270°C	+250°C -270°C	+250°C -270°C	+70°C -30°C	+100°C +120°C* -10°C	+70°C 0°C
最高工作温度 TOP TEMPERATURE °C	200°C	400°C	400°C	80°C	120°C 130°C*	80°C
导电性能 RESISTIVITY	✓ 导体 Conductor	✓ 导体 Conductor	✓ 导体 Conductor	X 绝缘体 Insulator	X 绝缘体 Insulator	X 绝缘体 Insulator
价格 PRICE	*	***	****	*	***	****
颜色 COLOUR	-	-	-	白色 White	乳白色 Cream	绿色 Green
材料密度 DENSITY	7,85	7,85	7,85	0,96	1,14	1,19
适用物料 APPLICATIONS	谷物类 工业类 Cereals Industry	食品类 腐蚀性物料 高温物料 Food Corrosion Temperature	食品类 强腐蚀性物料 Food Hight Corrosion	谷物类 食品类 Cereals Food	高温物料 磨损性物料 粘性物料 食品类 Temperature Abrasion Sticky Food	高温物料 尖锐性物料 粘性物料 Temperature Sharp Sticky

* 可定制 On request





JET®

提升机畚斗 ELEVATOR BUCKETS

p.6	HDPE, PA6, PU塑料畚斗 PLASTIC MATERIAL INJECTED HDPE, PA6, PU	JETCC®	
p.7	HDPE, PA6, PU塑料畚斗 PLASTIC MATERIAL INJECTED HDPE, PA6, PU	JETCC® Low Profile	
p.8	钢畚斗 PRESSED STEEL	JET®	
p.9	HDPE, PA6, PU塑料畚斗 PLASTIC MATERIAL INJECTED HDPE, PA6, PU	JET®	
p.10	钢畚斗 PRESSED STEEL	EUROJET®	
p.11	HDPE, PA6, PU塑料畚斗 PLASTIC MATERIAL INJECTED HDPE, PA6, PU	EUROJET®	
p.12	焊接钢畚斗 WELDED STEEL		
p.13	如何测量畚斗 HOW TO MEASURE A BUCKET		
p.14	畚斗螺栓 BOLTS		



塑料畚斗 PLASTIC MATERIAL INJECTED

HDPE, PA6, PU

谷物-轻型物料-颗粒状物料-工业类物料
Cereals - Light materials - Pellets - Industrial materials

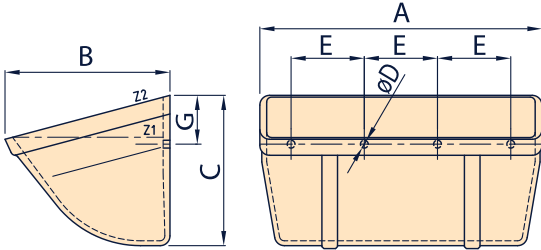

N°	A mm	B mm	C mm	安装孔 Holes			容积 Capacity /L		畚斗数/米 Buckets /mtr	重量 Weight / Kg				
				数量 Nbr	D mm	E mm	G mm	Z2 (°)		Z1 (°)	HDPE	PA 6	PU	
JET CC 4x3	10/090	114	90	80	2	∅7	63	20	0,40	0,30	11,25	0,10	0,12	0,12
JET CC 5x4	13/100	138	115	100	2	∅7	80	30	0,75	0,61	8,75	0,17	0,20	0,21
JET CC 6x4	16/100	164	115	100	2	∅7	110	30	0,95	0,74	8,75	0,23	0,27	0,29
JET CC 7x4	18/100	186	115	100	3	∅7	68	30	1,13	0,87	8,75	0,26	0,31	0,32
JET CC 7x5	18/140	192	145	130	3	∅7	68	35	1,74	1,35	7,15	0,38	0,45	0,47
JET CC 8x5	20/140	216	145	130	3	∅7	78	35	2,00	1,56	7,15	0,40	0,48	0,52
JET CC 9x5	23/140	242	145	130	3	∅7	92	35	2,22	1,71	7,15	0,46	0,55	0,57
JET CC 10x5	26/140	268	145	130	3	∅7	105	35	2,53	1,97	7,15	0,49	0,58	0,61
JET CC 8x6	20/170	215	170	155	3	∅7	78	45	2,90	2,10	6,00	0,54	0,64	0,67
JET CC 9x6	23/170	242	170	155	3	∅7	92	45	3,30	2,52	6,00	0,60	0,71	0,74
JET CC 10x6	26/170	266	170	155	3	∅7	105	45	3,70	2,75	6,00	0,64	0,76	0,79
JET CC 11x6	28/170	292	170	155	4	∅7	76	45	4,10	3,10	6,00	0,69	0,82	0,86
JET CC 12x6	32/170	317	170	155	4	∅7	78	45	4,30	3,31	6,00	0,76	0,89	0,94
JET CC 11x7	30/200	302	200	175	4	∅9	76	50	5,70	4,43	5,25	0,99	1,18	1,23
JET CC 11x7 D	30/200	285	200	205	3	∅9	100	50	5,75	4,38	4,60	1,36	1,62	1,69
JET CC 12x7	32/200	326	200	175	4	∅9	86	50	6,18	4,79	5,25	1,20	1,43	1,49
JET CC 12x7 D	32/200	340	200	205	4	∅9	86	50	7,00	5,33	4,60	1,57	1,78	1,95
JET CC 14x7	37/200	378	200	175	5	∅9	76	50	7,30	5,62	5,25	1,19	1,41	1,48
JET CC 20x7	52/200	532	200	178	6	∅9	90	50	10,50	8,30	5,25	2,20	2,61	2,80
JET CC 11x8	30/230	302	230	205	4	∅9	76	55	6,90	5,88	4,60	1,41	1,67	1,75
JET CC 12x8	32/230	320	223	210	4	∅9	86	55	8,30	6,29	4,60	1,51	1,79	1,87
JET CC 14x8	37/230	380	230	205	5	∅9	76	55	9,70	7,57	4,60	1,70	2,02	2,11
JET CC 16x8	42/230	430	230	205	6	∅9	73	55	11,10	8,66	4,60	1,90	2,26	2,36
JET CC 18x8	47/230	482	230	205	6	∅9	80	55	12,50	9,61	4,60	2,10	2,49	2,60
JET CC 20x8	52/230	532	230	205	6	∅9	90	55	13,90	10,86	4,60	2,28	2,71	2,83
JET CC 22x8	57/230	582	230	205	6	∅9	100	55	15,30	12,12	4,60	2,47	2,93	3,06

*公差Tolerances: 尺寸Size +/-2%

配平头螺栓 (见14页)
Use flat lug bolt (see page 14)

可根据客户要求钻孔
Other punching holes on request

非合同文件
No contractual document



塑料畚斗

PLASTIC MATERIAL INJECTED HDPE, PA6, PU

谷物-轻型物料-颗粒状物料-工业类物料
Cereals - Light materials - Pellets - Industrial materials

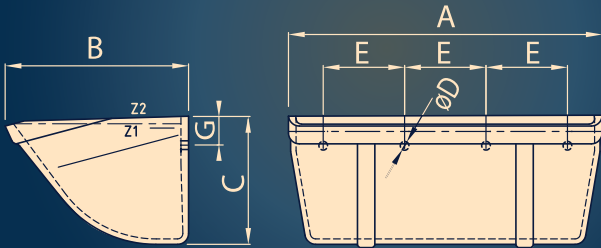

N°	A mm	B mm	C mm	安装孔 Holes			容积 Capacity /L		畚斗数/米 Buckets /mtr	重量 Weight / Kg			
				数量 Nbr	D mm	E mm	G mm	Z2 (ø)		Z1 (ø)	HDPE	PA 6	PU
JET CC 4x3	10/090	114	90	80	On request 可定制			0,40	0,30	11,25	0,10	0,12	0,12
JET CC 5x4	13/100	138	115	75		0,65	0,61	11,25	0,15	0,18	0,19		
JET CC 6x4	16/100	164	115	75		0,78	0,74	11,25	0,21	0,25	0,26		
JET CC 7x4	18/100	186	115	75		0,92	0,87	11,25	0,24	0,29	0,30		
JET CC 7x5	18/140	192	145	100		1,52	1,35	8,50	0,33	0,39	0,41		
JET CC 8x5	20/140	216	145	100		1,74	1,56	8,50	0,35	0,41	0,45		
JET CC 9x5	23/140	242	145	100		1,94	1,71	8,50	0,40	0,48	0,50		
JET CC 10x5	26/140	268	145	100		2,21	1,97	8,50	0,43	0,51	0,53		
JET CC 8x6	20/170	215	170	120		2,38	2,10	7,50	0,47	0,56	0,58		
JET CC 9x6	23/170	242	170	120		2,70	2,52	7,50	0,53	0,63	0,66		
JET CC 10x6	26/170	266	170	120		3,05	2,75	7,50	0,56	0,67	0,69		
JET CC 11x6	28/170	292	170	120		3,35	3,10	7,50	0,60	0,71	0,74		
JET CC 12x6	32/170	317	170	120		3,45	3,31	7,50	0,67	0,78	0,82		
JET CC 11x7	30/200	302	200	145		4,85	4,43	6,50	0,90	1,07	1,12		
JET CC 11x7 D	30/200	285	200	170		5,75	4,38	4,60	1,27	1,51	1,57		
JET CC 12x7	32/200	326	200	145		5,25	4,79	6,50	1,05	1,25	1,30		
JET CC 12x7 D	32/200	340	200	170		7,00	5,33	4,60	1,48	1,76	1,84		
JET CC 14x7	37/200	378	200	145		6,20	5,62	6,50	1,08	1,28	1,34		
JET CC 20x7	52/200	532	200	145		9,25	8,30	6,50	2,03	2,42	2,60		
JET CC 11x8	30/230	302	230	170		5,90	5,88	5,50	1,30	1,54	1,61		
JET CC 12x8	32/230	320	223	170		7,10	6,29	5,50	1,38	1,64	1,71		
JET CC 14x8	37/230	380	230	170		8,30	7,57	5,50	1,56	1,85	1,93		
JET CC 16x8	42/230	430	230	170		9,50	8,66	5,50	1,74	2,07	2,16		
JET CC 18x8	47/230	482	230	170		10,70	9,61	5,50	1,92	2,28	2,38		
JET CC 20x8	52/230	532	230	170		11,90	10,86	5,50	2,08	2,47	2,58		
JET CC 22x8	57/230	582	230	170		13,10	12,12	5,50	2,26	2,68	2,80		

*公差Tolerances: 尺寸Size +/-2%

配平头螺栓 (见14页)
Use flat lug bolt (see page 14)

可根据客户要求钻孔
Other punching holes on request

非合同文件
No contractual document

钢畚斗

PRESSED STEEL

碳钢 Carbon Steel, 不锈钢304L Stainless Steel 304L, 不锈钢316L Stainless Steel 316L

谷物-轻型物料-颗粒状物料-粘性物料-工业类物料

Cereals - Light materials - Pellets - Sticky materials - Industrial materials

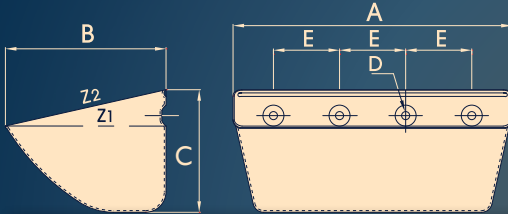

N°	A mm	B mm	C mm	安装孔 Holes			容积 Capacity/L		畚斗数/米 Buckets /mtr	重量 Weight / Kg							
				数量 Nbr	D mm	E mm	Z ₂ (c)	Z ₁ (c)		1,0 mm	1,2 mm	1,5 mm	2,0 mm	2,5 mm	3,0 mm	4,0 mm	
JET 08-080	85	80	58	2	8	43	0,21	0,18	15	0,11							
JET 10-090	105	92	70	2	8	50	0,38	0,26	14	0,15							
JET 12-100	125	103	80	2	8,5	67	0,62	0,45	11,50		0,27						
JET 13-120	138	125	90	2	8,5	70	0,77	0,65	10,50				0,40				
JET 14-120	146	120	90	2	8,5	70	0,87	0,71	10,50				0,40				
JET 15-140	154	140	108	2	9	70	1,25	0,95	8,50				0,54				
JET 18-140	188	147	112	2	9	100	1,71	1,38	8,50				0,65				
JET 20-140	207	142	110	2	9	100	1,79	1,37	8,50				0,73				
JET 22-140	227	142	110	2	9	120	2,00	1,58	8,50				0,77				
JET 23-140	237	142	110	2	9	120	2,08	1,60	8,50				0,81				
JET 20-160	205	169	132	2	11	100	2,60	2,03	7,40					1,18			
JET 23-160	235	169	132	2	11	120	3,00	2,40	7,40					1,33			
JET 24-160	245	169	132	2	11	140	3,18	2,46	7,40					1,41			
JET 26-160	265	169	132	3	11	80	3,50	2,80	7,40					1,50			
JET 28-160	285	169	132	3	11	80	3,76	2,95	7,40					1,59			
JET 30-160	305	169	132	3	11	100	4,00	3,00	7,40					1,65			
JET 33-160	335	169	132	3	11	110	4,32	3,17	7,40					1,79			
JET 35-160	356	176	128	3	11	120	4,53	3,47	7,40					1,87			
JET 37-160	375	176	128	4	11	90	4,85	3,55	7,40					1,91			
JET 20-180	209	188	147	2	11	110	3,15	2,28	6,50					1,24			
JET 24-180	249	188	147	2	11	140	3,90	2,83	6,50					1,53			
JET 26-180	269	188	147	3	11	80	4,30	3,15	6,50					1,57			
JET 28-180	289	188	147	3	11	80	4,60	3,42	6,50					1,71			
JET 30-180	309	188	147	3	11	100	5,00	3,70	6,50					1,80			
JET 33-180	339	188	147	3	11	110	5,55	4,10	6,50					1,94			
JET 35-180	359	188	147	3	11	120	5,90	4,37	6,50					2,05			
JET 37-180	379	188	147	4	11	90	6,30	4,65	6,50						2,73		
JET 42-180	425	188	140	4	11	100	7,35	5,50	6,50						3,10		
JET 25-215	255	216	162	3	11	80	5,20	4,00	5,88					1,90			
JET 28-215	285	216	162	3	11	80	5,90	4,65	5,88					2,09			
JET 30-215	312	216	162	3	11	100	6,70	5,20	5,88					2,24			
JET 33-215 A	340	220	162	3	11	110	7,20	5,65	5,88						3,00		
JET 33-215 B	340	220	162	3	11	120	7,20	5,65	5,88						3,00		
JET 35-215	360	220	164	3	11	120	7,60	5,85	5,88						3,20		
JET 37-215	380	220	164	4	11	90	8,60	6,50	5,88						3,32		
JET 44-215 A	454	220	164	4	11	110	10,00	7,70	5,88						3,78		
JET 44-215 B	454	220	164	5	11	90	10,00	7,70	5,88						3,78		
JET 47-215	480	220	164	4	11	120	10,53	8,50	5,88						4,04		
JET 50-215 A	510	220	164	4	11	135	11,20	9,00	5,88						4,30		
JET 50-215 B	510	220	164	5	11	100	11,20	9,00	5,88						4,30		
JET 53-215	540	220	164	6	11	80	11,87	9,50	5,88						4,56	5,50	
JET 56-215	570	220	164	6	11	90	12,54	10,00	5,88						4,82	5,82	
JET 63-215	640	220	164	7	11	90	14,12	11,30	5,88						5,42	6,50	
JET 33-250	340	253	190	4	11	80	8,95	6,70	5							4,10	5,50
JET 35-250	360	253	190	4	11	80	9,50	7,30	5							4,35	5,80
JET 37-250	380	253	190	4	11	90	10,10	7,60	5							4,60	6,15
JET 42-250	430	253	190	5	11	80	11,50	8,70	5							5,25	7,00
JET 44-250	450	253	190	5	11	90	12,10	9,15	5							5,50	7,35
JET 47-250	480	253	190	5	11	90	13,00	9,75	5							5,80	7,75
JET 53-250	540	253	190	6	11	80	14,60	11,00	5							6,60	8,80
JET 56-250	570	253	190	6	11	90	15,35	11,60	5							6,95	9,30
JET 63-250	640	253	190	7	11	90	17,20	13,00	5							7,80	10,40

配鼓式螺栓 (见14页) Use countersunk lug bolt (see page 14)

非同合同文件 No contractual document

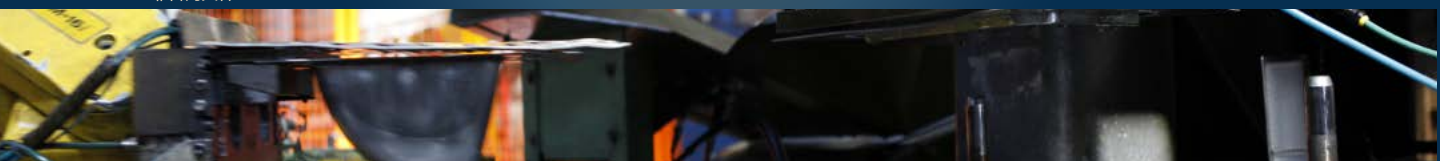

JET®

塑料畚斗 PLASTIC MATERIAL INJECTED HDPE, PA6, PU

谷物-轻型物料-颗粒状物料-粘性物料-工业类物料
Cereals - Light materials - Pellets - Sticky materials - Industrial materials

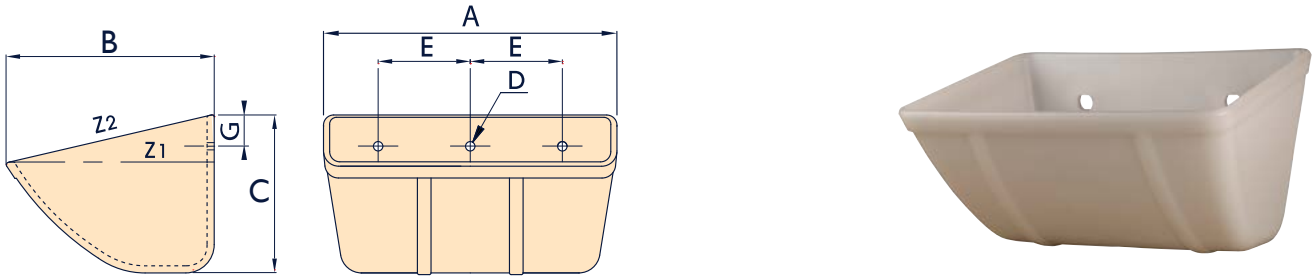

N°	A mm	B mm	C mm	安装孔 Holes			容积 Capacity / L		畚斗数/米 Buckets /mtr	重量 Weight / Kg			
				数量 Nbr	D mm	E mm	G mm	Z2 (e)		Z1 (e)	HDPE	PA6	PU
JET 10-090	110	96	72	2	9	50	18	0,36	0,24	13	0,073	0,087	0,091
JET 13-120	142	126	85	2	9	70	23	0,80	0,51	11	0,136	0,163	0,170
JET 15-140	156	152	112	2	9	70	30	1,42	1,13	8,5	0,232	0,277	0,289
JET 18-140	191	152	112	2	9	100	30	1,77	1,37	8,5	0,273	0,326	0,341
JET 20-140	207	152	112	2	9	100	30	1,95	1,62	8,5	0,315	0,376	0,393
JET 22-140	228	152	112	2	9	120	30	1,93	1,49	8,5	0,320	0,382	0,399
JET 23-170	242	185	142	2	11	120	35	3,25	2,40	6,5	0,475	0,540	0,595
JET 28-170	291	185	140	3	11	80	35	4,03	3,00	6,5	0,554	0,665	0,690
JET 20-180	212	191	149	2	11	110	45	3,12	2,40	6,5	0,480	0,575	0,615
JET 30-215	320	230	170	3	11	100	50	6,53	4,99	5,5	1,114	1,367	1,427
JET 33-215	350	230	172	3	11	120	50	7,36	5,47	5,5	1,118	1,336	1,395
JET 35-215	370	230	172	3	11	120	50	7,66	5,72	5,5	1,127	1,347	1,406
JET 37-215	391	230	172	4	11	90	50	7,97	5,97	5,5	1,347	1,610	1,680
JET 40-215	421	230	172	4	11	100	50	8,78	6,78	5,5	1,518	1,814	1,894
JET 42-215	440	228	168	5	11	90	50	9,09	7,05	5,6	1,537	1,885	1,960
JET 44-215	461	230	172	5	11	90	50	9,59	7,33	5,5	1,585	1,894	1,977
JET 50-215	520	228	168	5	11	100	50	11,70	9,00	5,6	1,750	2,091	2,183

*公差Tolerances: 尺寸Size +/- 2%

配平头螺栓 (见14页)
use flat lug bolt (see page 14)

可根据客户要求钻孔
Other punching holes on request

非合同文件
No contractual document



钢畚斗 PRESSED STEEL

碳钢 Carbon Steel, 不锈钢304L Stainless Steel 304L, 不锈钢316L Stainless Steel 316L

谷物-轻型物料-颗粒状物料-粘性物料-工业类物料

Cereals - Light materials - Pellets - Sticky materials - Industrial materials

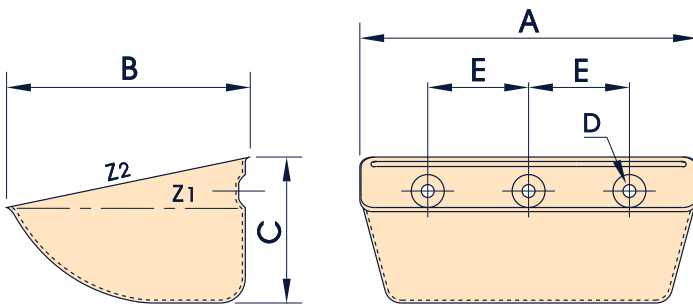

N°	A mm	B mm	C mm	安装孔 Holes			容积 Capacity/L		畚斗数/米 Buckets /mtr	重量 Weight/ Kg					
				数量 Nbr	D mm	E mm	Z2 (c)	Z1 (c)		1,0 mm	1,2 mm	1,5 mm	2,0 mm	2,5 mm	3,0 mm
EURO JET 12-100	125	104	78	2	8,5	67	0,55	0,35	12		0,23				
EURO JET 13-120	135	115	81	2	8,5	70	0,65	0,45	12		0,28				
EURO JET 16-130	165	130	87	2	8,5	100	0,95	0,60	12			0,44			
EURO JET 18-140	185	140	92	2	8,5	100	1,29	0,90	10,5			0,55			
EURO JET 20-140	200	136	97	2	11	100	1,41	1,04	10			0,63			
EURO JET 23-165	238	165	110	2	11	120	2,45	1,73	9				1,18		
EURO JET 25-165	258	165	110	3	11	77	2,70	2,00	9				1,27		
EURO JET 28-165	288	165	110	3	11	80	3,00	2,25	9				1,40		
EURO JET 30-180	308	187	120	3	11	100	3,70	2,45	8,13				1,55		
EURO JET 30-215	308	215	140	3	11	100	5,20	3,65	7,14				1,94	2,40	2,90
EURO JET 33-215	338	215	130	3	11	120	5,50	3,95	7,14				1,97	2,50	3,00
EURO JET 37-215	378	215	130	4	11	90	6,20	4,10	7,14				2,25	2,86	3,45
EURO JET 44-215	448	215	130	5	11	90	7,50	5,60	7,14				2,70	3,20	3,85

配鼓式螺栓 (见14页)
Use countersunk lug bolt (see page 14)

塑料畚斗 PLASTIC MATERIAL INJECTED HDPE, PA6, PU

谷物-轻型物料-颗粒状物料-粘性物料-重工业物料
Cereals - Light materials - Pellets - Sticky materials - Heavy industry

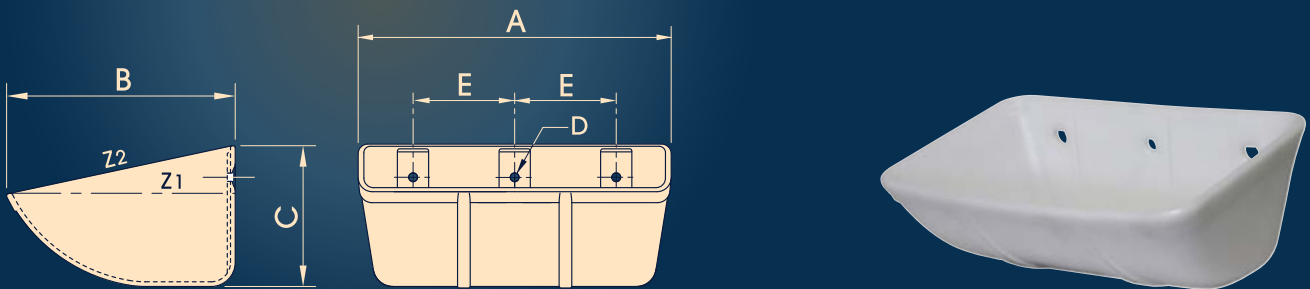

N°	A mm	B mm	C mm	安装孔 Holes			容积 Capacity /L		畚斗数/米 Buckets /mtr	重量 Weight / Kg		
				数量 Nbr	D mm	E mm	Z2 (e)	Z1 (e)		HDPE	PA 6	PU
EURO JET 10-090	110	97	69	2	8	50	0,33	0,24	14	0,077	0,092	0,096
EURO JET 13-120	145	122	83	2	8	70	0,69	0,46	11	0,126	0,151	0,157
EURO JET 15-120	160	131	85	2	8	80	0,94	0,60	11	0,156	0,186	0,195
EURO JET 18-140	188	149	93	2	8	100	1,20	0,84	10,5	0,264	0,315	0,329
EURO JET 20-165	207	176	115	2	11	100	2,17	1,67	9	0,361	0,431	0,450
EURO JET 23-165	242	172	117	2	11	120	2,42	1,60	9	0,380	0,454	0,474
EURO JET 28-165	292	170	116	3	11	80	2,90	2,00	9	0,459	0,548	0,573
EURO JET 30-180	318	186	135	3	11	100	4,04	2,97	8	0,766	0,915	0,955
EURO JET 33-215	339	222	145	3	11	120	4,44	3,19	7,14	0,746	0,891	0,931
EURO JET 37-215	383	219	142	4	11	90	6,06	4,20	7,14	0,822	0,982	1,025
EURO JET 44-215	455	223	143	5	11	90	7,39	4,59	7,14	1,148	1,372	1,432

*公差Tolerances: 尺寸Size +/-2%

配鼓式螺栓+平垫圈 (见14页)

Use countersunk lug bolt + flat washer (see page 14)

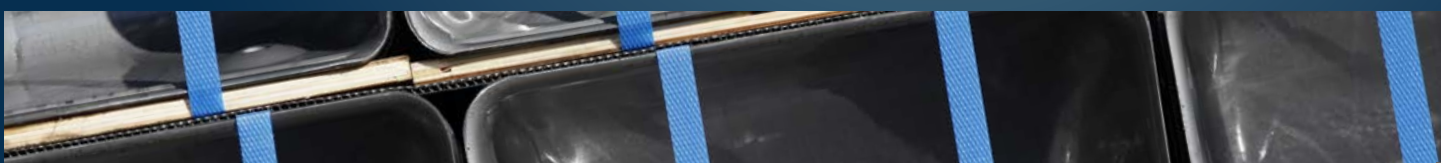

焊接钢畚斗 WELDED STEEL

重工业
Heavy industry

DIN 15232

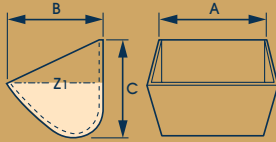

N°	A mm	B mm	C mm	Z1 (°)	畚斗数/米 Buckets /mtr
NJS 160-125	160	125	132	0,90	7,00
NJS 200-140	200	140	150	1,40	6,00
NJS 250-160	250	160	170	2,24	5,50
NJS 315-180	315	180	190	3,55	5,00
NJS 400-200	400	200	212	5,50	4,50
NJS 500-224	500	224	236	9,00	4,00
NJS 630-250	630	250	265	14,00	3,50
NJS 800-280	800	280	300	23,30	3,00

DIN 15234

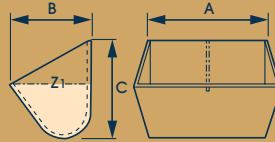

N°	A mm	B mm	C mm	Z1 (°)	畚斗数/米 Buckets /mtr
NJS 160-160	160	160	200	1,90	4,50
NJS 200-160	200	160	200	2,40	4,50
NJS 250-200	250	200	250	4,60	3,50
NJS 315-200	315	200	250	5,80	3,50
NJS 400-224	400	224	280	9,40	3,00
NJS 500-250	500	250	315	14,90	3,00
NJS 630-280	630	280	355	23,50	2,50
NJS 800-315	800	315	400	37,30	2,00
NJS 1000-355	1000	355	450	58,30	2,00

DIN 15233

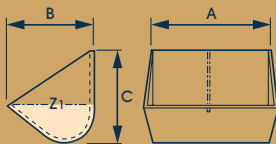

N°	A mm	B mm	C mm	Z1 (°)	畚斗数/米 Buckets /mtr
NJS 160-160	160	160	180	1,20	5,00
NJS 200-160	200	160	180	1,50	5,00
NJS 250-200	250	200	224	3,00	4,00
NJS 315-200	315	200	224	3,80	4,00
NJS 400-224	400	224	250	5,90	3,50
NJS 500-250	500	250	280	9,30	3,00
NJS 630-280	630	280	315	14,60	3,00
NJS 800-315	800	315	355	23,30	2,50
NJS 1000-355	1000	355	400	37,60	2,00

DIN 15235

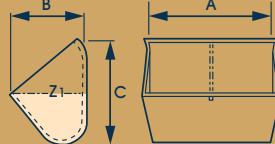

N°	A mm	B mm	C mm	Z1 (°)	畚斗数/米 Buckets /mtr
NJS 160-160	160	160	224	1,90	4,00
NJS 200-160	200	160	224	2,40	4,00
NJS 250-200	250	200	280	4,60	3,00
NJS 315-200	315	200	280	5,80	3,00
NJS 400-224	400	224	315	9,40	3,00
NJS 500-250	500	250	355	14,90	2,50
NJS 630-280	630	280	400	23,50	2,00
NJS 800-315	800	315	450	37,30	2,00
NJS 1000-355	1000	355	500	58,30	1,50

可选项

POSSIBLE OPTIONS ALL STEEL BUCKETS

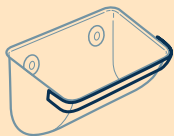

进料口加固
Welded front reinforcement

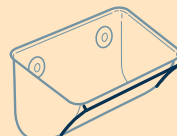

前面加固
Front reinforcement moulding

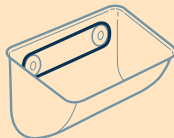

螺栓加固
Bolted rear reinforcement



螺栓安装处加固
Rear reinforcement moulding

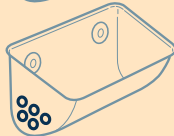

侧面钻孔
Lateral borings



底部钻孔
Bottom borings

特制畚斗 SPECIAL BUCKETS

可根据客户要求进行技术研发及报价
Technical research and quotation on request

如何测量畚斗 HOW TO MEASURE A BUCKET

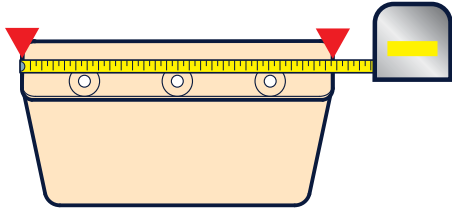

畚斗宽度
Width of the bucket:
测量外部边缘尺寸
External measurement

A

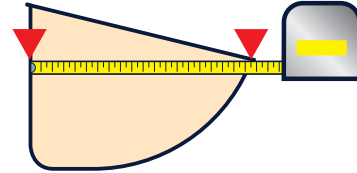

侧面宽度
Profile of the bucket:
畚斗背部靠墙，测量背部到边缘的水平距离
Bucket lying on its back against a wall
Measurement horizontal from the back to the edge

B

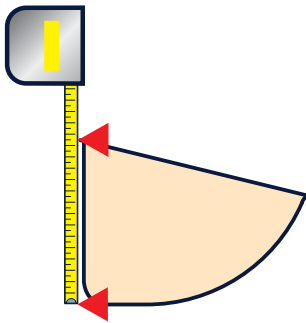

畚斗高度
Height of the bucket:
测量整体高度
Measurement of the total height

C

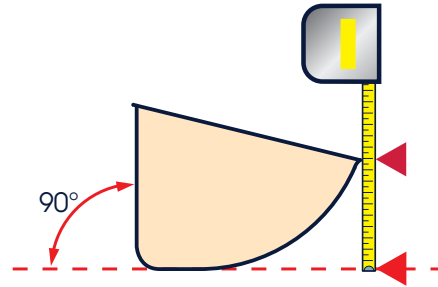

边缘高度
Height at the edge:
畚斗背部靠墙，测量水平面到边缘的高度
Bucket lying on its back against a wall
Measurement from the height to the edge

F

畚斗厚度
Thickness:
游标卡尺测量
Measurement of the thickness with a caliper rule

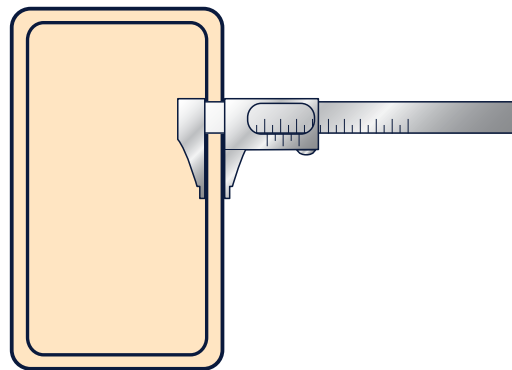

畚斗螺栓 BOLTS

鼓式

For bucket with recessed holes

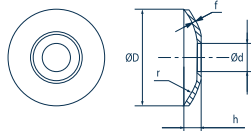
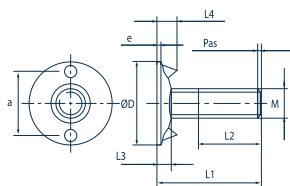

鼓式螺栓 Countersunk lug bolt	型号 Codification	M	L1	ØD	L2	Pas	L3	L4	a	eMax
镀锌 Zinc*										
	04VEZS08030	8	30	25	20	1,25	4,5	6	18	1
	04VEZS08035	8	35	25	25	1,25	4,5	6	18	1
	04VEZS10040	10	40	33	30	1,50	5,5	7	22	2

型号 Codification	M	ØD	ød	h	r	f
镀锌 Zinc*						
50ZREZ0829	8	29	8,5	5,2	22,8	1,2
50ZREZ1038	10	38	11	5,3	45,5	2,0

型号 Codification	螺母 Nuts 镀锌 Zinc*	型号 Codification	自锁螺母 Self locking nuts 镀锌 Zinc*
04EHZ08	M8	04EFZ08	M8
04EHZ10	M10	04EFZ10	M10



* 可选不锈钢材质 Available in stainless steel

平头

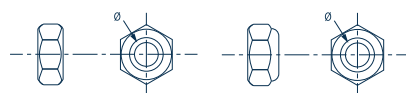
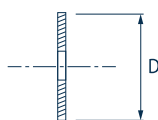
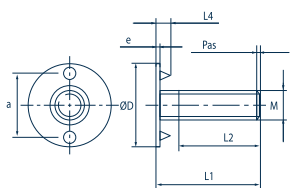
For bucket with no recessed holes

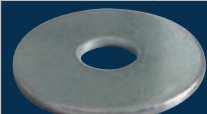

平头螺栓 Flat lug bolt	型号 Codification	M	L1	ØD	L2	Pas	L4	a	e
镀锌 Zinc*									
	04VEZP06030	6	30	20	25	1,00	3,7	15	1,5
	04VEZP08035	8	35	30	28	1,25	4,5	18	2
	04VEZP10040	10	40	33	32	1,50	5,5	22	2,5

塑料畚斗 For plastic bucket				钢畚斗 For steel bucket					
									
型号Codification	M	ØD	ød	f	型号Codification	M	ØD	ød	f
镀锌 Zinc*									
04RPZ0624	6	24	6,3	1,2	04RPZ0614	6	14	6,3	1
04RPZ0830	8	30	8,3	1,5	04RPZ0818	8	18	8,3	1,5
04RPZ1036	10	36	10,5	2,0	04RPZ1022	10	22	10,5	2,0

型号 Codification	螺母 Nuts 镀锌 Zinc*	型号 Codification	自锁螺母 Self locking nuts 镀锌 Zinc*
04EHZ06	M6	04EFZ06	M6
04EHZ08	M8	04EFZ08	M8
04EHZ10	M10	04EFZ10	M10

* 可选不锈钢材质 Available in stainless steel

皮带连接件 BELT JUNCTION

锻钢 Drop forged steel

MAXIGRIP 1 - ≤ 630 N/mm

MAXIGRIP 2 - 800 N/mm to 1600 N/mm

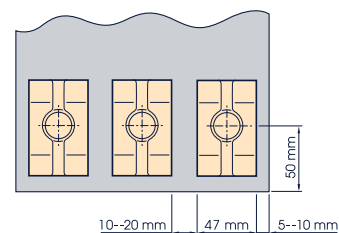
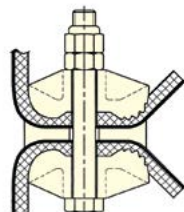
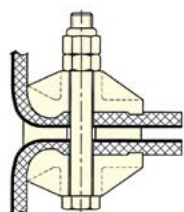



BELTJET®

提升机皮带 ELEVATOR BELTS

p.16

JET® OIL

耐油型提升机皮带 OIL RESISTANT ELEVATOR BELT



p.17

JET® OIL VLE

VLE耐油型提升机皮带 VERY LOW ELONGATION
OIL RESISTANT ELEVATOR BELT

不易打滑
Without slipping

IRM 903<15%

全新
NEW

p.18

JET® FLAM

阻燃型提升机皮带 FLAME RESISTANT ELEVATOR BELT



p.19

JET® FLAM VLE

SUPER OIL 100% NBR
VLE超耐油阻燃型提升机皮带 VERY LOW ELONGATION
FLAME RESISTANT ELEVATOR BELT

不易打滑
Without slipping

GB/T 3685
IRM 903<5%

全新
NEW

p.20

JET® ABRA

耐磨型提升机皮带 ANTI ABRASIVE ELEVATOR BELT



p.21

JET® THERM EU

耐高温型提升机皮带 HIGH TEMPERATURE ELEVATOR BELT



p.22

JET® FDA VLE EU Ex

VLE食品级提升机皮带 VERY LOW ELONGATION
FOOD QUALITY ELEVATOR BELT

不易打滑
Without slipping

FDA
ISO 340
IRM 903<5%

全新
NEW



DURABLE



ANTIABRASIVE



ANTISTATIC



TEMPERATURE



耐油型提升机皮带 OIL RESISTANT ELEVATOR BELT

胶层特性 COATING:

- 丁苯/丁腈橡胶 SBR/NBR black rubber
- 高耐油 Vegetal and animal high fat resistant
- 耐磨 Anti abrasive
- 抗静电 Antistatic

带芯织物 CARCASS TEXTILE:

- 聚酯和锦纶 Chain polyester, Weft polyamide

适用温度范围 USAGE TEMPERATURE:

- 零下20摄氏度到70摄氏度
-20°C to +70°C

技术参数表 CHARACTERISTICS

强度 Rupture Strength (N/mm)	400	630	800	1000	1250	1600
带芯层数 Number of Plies	3	3	4	4	4	4
胶层厚度 Thicknesses* (mm) : 盖胶 Coating 总厚度 Total	3+1,5 7,1	3+1,5 8,0	3+1,5 9,3	3+1,5 9,7	3+1,5 10,1	3+1,5 11,3
平均重量 Average weight (kg/m ²)	8,70	9,60	11,30	12,10	13,10	13,90
最小包胶头轮直径 Minimum Roll Diameter (mm). Covered Pulley	300	400	500	600	800	800
建议皮带最大宽度 Width maximum advised (mm)	500	600	800	1290	1500	1500

*公差 Tolerances: 胶层厚度 Coating Thicknesses +/- 0,2 mm — 总厚度 Total Thickness +/- 1 mm — 宽度 Width +/- 1%

**全新
NEW**

**不易打滑
Without slipping**



VLE耐油型提升机皮带 低延伸率 VERY LOW ELONGATION

安装 INSTALLATION:

- 安装简易 Simplified installation = One final tenseness
- 不易打滑 Enhanced security = Not slip
- 不需维护 Maintenance free

胶层特性 COATING:

- 延伸率低1,0% Very Low Elongation 1,0%
- 丁苯/丁腈橡胶 SBR/NBR black rubber
- 高耐油 Vegetal and animal high fat resistant
- 耐磨 Anti abrasive
- 抗静电 Antistatic

带芯织物 CARCASS TEXTILE:

- 聚酯和锦纶 Chain polyester, Weft and link polyamide

适用温度范围 USAGE TEMPERATURE:

- 零下20摄氏度到80摄氏度
-20°C to +80°C



DURABLE



ANTIABRASIVE



ANTISTATIC



TEMPERATURE

技术参数表 CHARACTERISTICS

强度 Rupture Strength (N/mm)	400	630	800	1000	1250	1600
带芯层数 Number of Plies	1	1	1	2	2	2
胶层厚度 Thicknesses* (mm): 盖胶 Coating 总厚度 Total	3+1 6,5	3+1 6,9	3+1 7,6	3+1 9,2	3+1 9,9	3+1 10,6
平均重量 Average weight (kg/m ²)	8,30	8,80	9,50	10,60	11,50	12,50
最小包胶头轮直径 Minimum Roll Diameter (mm). Covered Pulley	200	250	315	630	630	800
建议皮带最大宽度 Width maximum advised (mm)	650	1000	1250	1600	1800	1800

*公差 Tolerances: 胶层厚度 Coating Thicknesses +/- 0,2 mm — 总厚度 Total Thickness +/- 1 mm — 宽度 Width +/- 1%

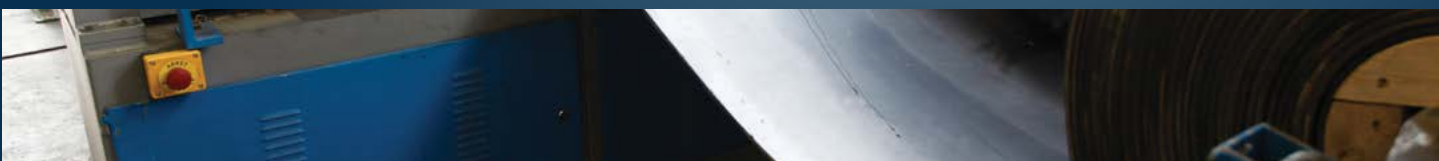



IRM 903 <15%
FAT-RESISTANT



DURABLE



GB/T 9867
<200mm³
ANTIABRASIVE



GB/T 3684<300MD
ANTISTATIC



TEMPERATURE

阻燃型提升机皮带 FLAME RESISTANT ELEVATOR BELT

胶层特性 COATING:

- 丁苯/丁腈橡胶 SBR/NBR black rubber
- 阻燃 Flame resistant
- 高耐油 Vegetal and animal high fat resistant
- 耐磨 Anti abrasive
- 抗静电 Antistatic

带芯织物 CARCASS TEXTILE:

- 聚酯和锦纶 Chain polyester, Weft polyamide

适用温度范围 USAGE TEMPERATURE:

- 零下20摄氏度到70摄氏度
-20°C to +70°C

技术参数表 CHARACTERISTICS

强度 Rupture Strength (N/mm)	400	630	800	1000	1250	1600
带芯层数 Number of Plies	3	3	4	4	4	4
胶层厚度 Thicknesses* (mm) : 盖胶 Coating 总厚度 Total	3+1,5 7,1	3+1,5 8,0	3+1,5 9,3	3+1,5 9,7	3+1,5 10,1	3+1,5 11,3
平均重量 Average weight (kg/m ²)	9,20	10,20	12,00	12,90	13,50	14,90
最小包胶头轮直径 Minimum Roll Diameter (mm). Covered Pulley	300	400	500	600	800	800
建议皮带最大宽度 Width maximum advised (mm)	500	600	800	1290	1500	1500

*公差 Tolerances: 胶层厚度 Coating Thicknesses +/- 0,2mm — 总厚度 Total Thickness +/- 1mm — 宽度 Width +/- 1%

JET[®] FLAM^{VLE}

SUPER OIL 100% NBR

**全新
NEW**

**不易打滑
Without slipping**



VLE超耐油阻燃型提升机皮带 低延伸率 VERY LOW ELONGATION

安装 INSTALLATION:

- 安装简易 Simplified installation = One final tenseness
- 不易打滑 Enhanced security = Not slip
- 不需维护 Maintenance free

胶层特性 COATING:

- 延伸率低1,0% Very Low Elongation 1,0%
- 100%丁腈橡胶 100% NBR black rubber
- 阻燃 Flame resistant
- 超耐油 Mineral vegetal and animal super fat resistant
- 耐磨 Anti abrasive
- 抗静电 Antistatic

带芯织物 CARCASS TEXTILE:

- 聚酯和锦纶 Chain polyester, Weft and link polyamide

适用温度范围 USAGE TEMPERATURE:

- 零下20摄氏度到80摄氏度
-20°C to +80°C



DURABLE



ANTIABRASIVE



ANTISTATIC



TEMPERATURE

技术参数表 CHARACTERISTICS

强度 Rupture Strength (N/mm)	400	630	800	1000	1250	1600
带芯层数 Number of Plies	1	1	1	2	2	2
胶层厚度 Thicknesses* (mm) : 盖胶 Coating 总厚度 Total	3+1 6,5	3+1 6,9	3+1 7,6	3+1 9,2	3+1 9,9	3+1 10,6
平均重量 Average weight (kg/m ²)	8,50	9,10	9,80	10,90	11,80	12,90
最小包胶头轮直径 Minimum Roll Diameter (mm). Covered Pulley	200	250	315	630	630	800
建议皮带最大宽度 Width maximum advised (mm)	650	1000	1250	1600	1800	1800

*公差 Tolerances: 胶层厚度 Coating Thicknesses +/- 0,2 mm — 总厚度 Total Thickness +/- 1 mm — 宽度 Width +/- 1%

非合同文件
No contractual document





DURABLE



ANTISTATIC



TEMPERATURE



耐磨型提升机皮带 ANTI ABRASIVE ELEVATOR BELT

胶层特性 COATING:

- 丁苯/丁腈橡胶 SBR/NBR black rubber
- 耐磨 Anti abrasive
- 抗静电 Antistatic

带芯织物 CARCASS TEXTILE:

- 聚酯和锦纶 Chain polyester, Weft polyamide

适用温度范围 USAGE TEMPERATURE:

- 零下20摄氏度到70摄氏度
-20°C to +70°C

技术参数表 CHARACTERISTICS

强度 Rupture Strength (N/mm)	400	630	800	1000	1250	1600
带芯层数 Number of Plies	3	3	4	4	4	4
胶层厚度 Thicknesses* (mm) : 盖胶 Coating 总厚度 Total	3+1,5 7,1	3+1,5 8,0	3+1,5 9,3	3+1,5 9,7	3+1,5 10,1	3+1,5 11,3
平均重量 Average weight (kg/m ²)	8,40	9,20	10,80	11,80	12,60	13,50
最小包胶头轮直径 Minimum Roll Diameter (mm). Covered Pulley	300	400	500	600	800	800
建议皮带最大宽度 Width maximum advised (mm)	500	600	800	1290	1500	1500

*公差 Tolerances: 胶层厚度 Coating Thicknesses +/- 0,2 mm — 总厚度 Total Thickness +/- 1 mm — 宽度 Width +/- 1%



DURABLE



ANTISTATIC

耐高温型提升机皮带 HIGH TEMPERATURE ELEVATOR BELT

胶层特性 COATING:

- 三元乙丙橡胶 EPDM black rubber
- 耐磨 Anti abrasive
- 抗静电 Antistatic

带芯织物 CARCASS TEXTILE:

- 聚酯和锦纶 Chain polyester, Weft polyamide

适用温度范围 USAGE TEMPERATURE:

- 零下20摄氏度到150摄氏度
-20°C to +150°C

技术参数表 CHARACTERISTICS

强度 Rupture Strength (N/mm)	500*	630	800	1000*	1250*	1600*
带芯层数 Number of Plies	3	4	4	4	4	4
胶层厚度 Thicknesses* (mm): 盖胶 Coating 总厚度 Total	3+1 7,2	3+1 8,6	3+1 9,3	3+1 10,0	3+1 11,5	3+1 12,5
平均重量 Average weight (kg/m ²)	8,4	9,9	10,4	11,0	11,4	13,0
最小包胶头轮直径 Minimum Roll Diameter (mm). Covered Pulley	315	400	500	630	800	800
建议皮带最大宽度 Width maximum advised (mm)	500	800	1000	1250	1600	1600

*公差 Tolerances: 胶层厚度 Coating Thicknesses +/- 0,2 mm — 总厚度 Total Thickness +/- 1 mm — 宽度 Width +/- 1% — * 需定制 On request

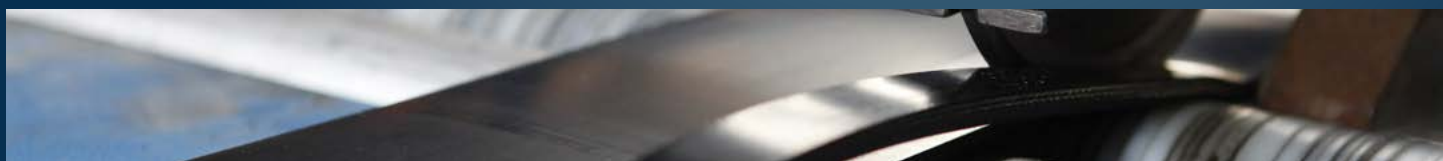



**全新
NEW**

**不易打滑
Without slipping**

VLE食品级提升机皮带 低延伸率 VERY LOW ELONGATION ATEX 20



DURABLE



ANTIABRASIVE



ANTISTATIC



TEMPERATURE

安装 INSTALLATION:

- 安装简易 Simplified installation = One final tenseness
- 不易打滑 Enhanced security = Not slip
- 不需维护 Maintenance free

胶层特性 COATING:

- 延伸率低 0,8% Very Low Elongation 0,8%
- 丁腈橡胶 NBR white rubber
- 阻燃 Flame resistant
- 耐油 Vegetal and animal fat resistant
- 耐磨 Anti abrasive
- 抗静电 Antistatic

带芯织物 CARCASS TEXTILE:

- 聚酯和锦纶 Chain polyester, Weft and link polyamide

适用温度范围 USAGE TEMPERATURE:

- 零下25摄氏度到80摄氏度 / 最高温度:100摄氏度
-25°C to +80°C / Peak +100°C

技术参数表 CHARACTERISTICS

	400	630	800	1000	1250	1600
强度 Rupture Strength (N/mm)	400	630	800	1000	1250	1600
带芯层数 Number of Plies	1	1	1	2	2	2
胶层厚度 Thicknesses* (mm) : 盖胶 Coating 总厚度 Total	3+1 5,9	3+1 6,1	3+1 6,9	3+1 10,0	3+1 10,2	3+1 11,9
平均重量 Average weight (kg/m ²)	7,9	8,2	9,1	11,1	11,3	13,1
最小包胶头轮直径 Minimum Roll Diameter (mm). Covered Pulley	200	250	315	630	630	800
建议皮带最大宽度 Width maximum advised (mm)	650	1000	1250	1600	1800	1800

*公差 Tolerances: 胶层厚度 Coating Thicknesses +/- 0,2 mm — 总厚度 Total Thickness +/- 1 mm — 宽度 Width +/- 1%



斗式提升机配件 components for bucket elevator

产品 PRODUCTS

- 塑料畚斗和钢畚斗
Plastic and steel buckets
- 提升机皮带
Elevator belts
- 畚斗螺栓
Bucket bolts

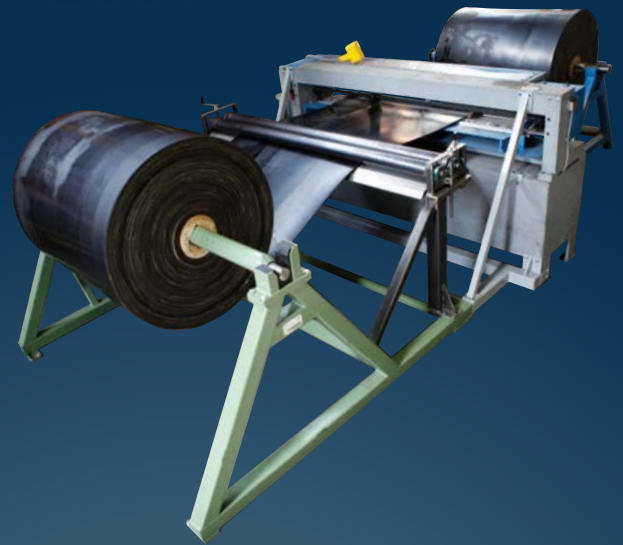

服务 SERVICES

- 库存充足
Big stock
- 畚斗打孔服务
Buckets : punching
- 皮带切割 / 打孔服务
Belt cutting and punching service
- 技术支持
Technical support



STIF SUZHOU
sales@stif.cn — www.stif.cn



www.stif.cn

斯缙福机械（苏州）有限公司
STIF (Suzhou) Components Co., Ltd

公司地址：江苏省苏州市吴中区东太湖路2318号7#厂房（215103）

Address：Unit 7, No.2318 East Taihu Rd., Wuzhong District,
Suzhou City, Jiangsu Province, China (215103)

电话(Tel.): +86 512 6656 8968

传真(Fax): +86 512 6656 9128

电子邮箱(Email)：sales@stif.cn

网址(Website)：www.stif.cn

EUROPE



STIF (Head Office) Factory

Z.A. de la Lande
49170 Saint Georges sur Loire
FRANCE
Tel.: +33 2 41 72 16 82
Fax: +33 2 41 39 32 12
E mail: sales@stifnet.com
Web: www.stifnet.com

STIF IBERICA Sales Office

La Selva - 21 Nave 2
Pol. Indus. Les Salines
08880 Cubelles
BARCELONA - ESPAÑA
Tel.: +34 938 950 262
Fax: +34 938 950 298
E mail: ventas@stifiberica.es
Web: www.stifnet.com

STIF EASTERN EUROPE

Sales Office
Lev Landau av. 155-B, off.206
61060 KHARKIV
UKRAINE
E mail: stifee@stifnet.com
Web: www.stifnet.com

AMERICA

STIF AMERICA Sales Office

Oficina 4-04
Centro Empresarial Mar del Sur
Calle Primera El Carmen
PANAMÁ
Tel.: +507 393-3787
Fax: +507 393-7467
E mail: stifamerica@stifnet.com
Web: www.stifnet.com

ASIA



STIF SUZHOU Factory

Unit 7, N° 2318 East Taihu Road
Wuzhong District, Suzhou City
Jiangsu Province, CHINA
Tel.: +86 512 6656 8968
Fax: +86 512 6656 9128
E mail: sales@stif.cn
Web: www.stif.cn

STIF ASIA Sales Office

2 Jurong East St. 21
#04-28K IMM Building
SINGAPORE 609601
Tel.: +65 6563-2098
Fax: +65 6562-6083
E mail: sales@stif.com.sg
Web: www.stifnet.com

STIF INDONESIA Sales Office

Jl. Raya Jatibening No. 1 A RT 006 RW 001,
Jatibening, Pondokgede,
Kotamadya Bekasi, Jawa Barat
Indonesia 17412
Tel.: +62 21 8499 6745
Fax: +62 21 8499 5151
E mail: indo@stif.com.sg
Web: www.stifnet.com

